

T:\2019\1923\CHelsea_Senior_Living - 1600 River Road, Fair Lawn, NJ\CAD\DWG\19233-00-10 BERGEN.AVI SIGN DETAIL.DWG

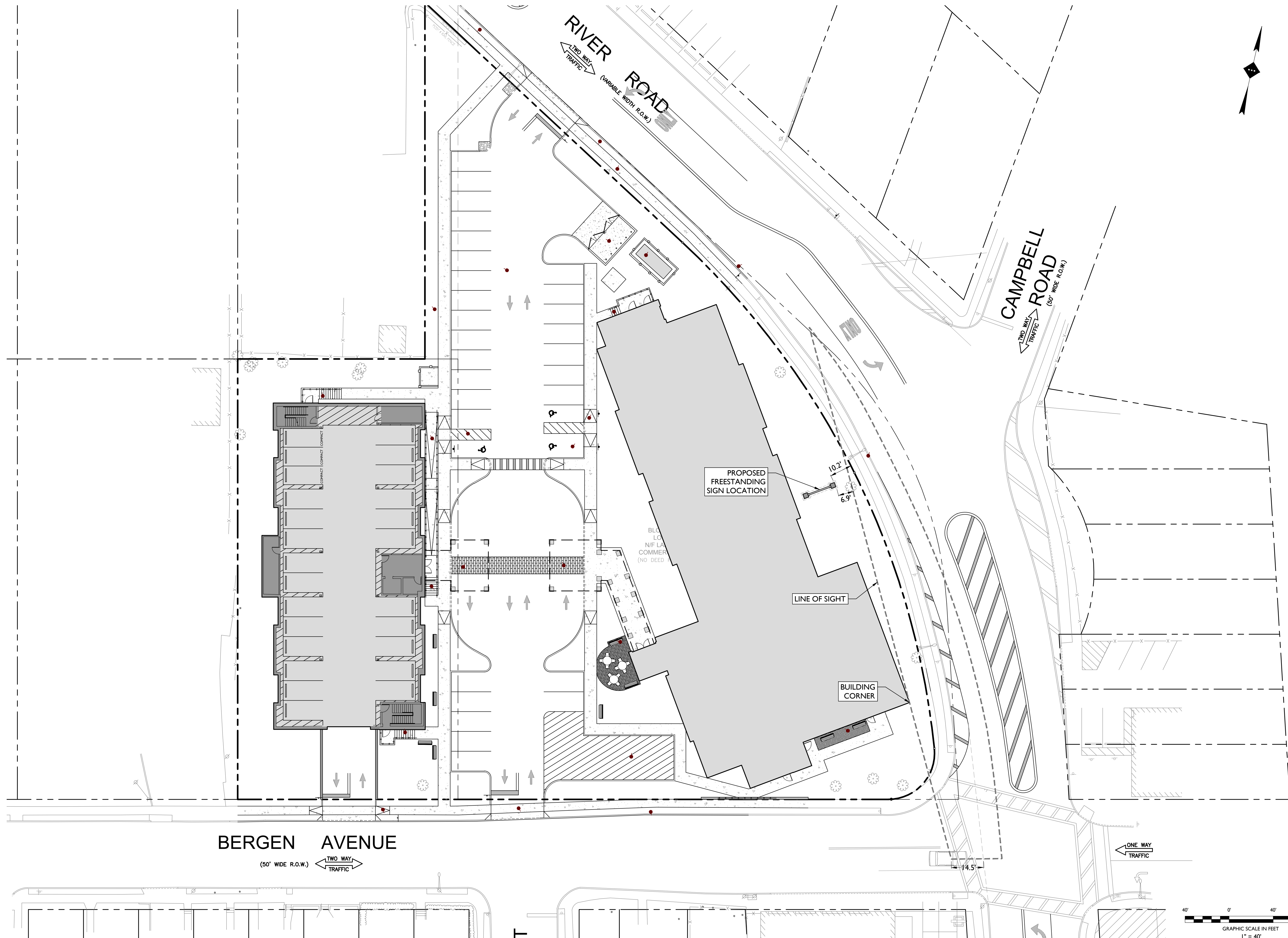

ISSUE	DATE	BY	DESCRIPTION
18	5/10/2023	JJR	REVISED FREESTANDING SIGN DIMENSIONS
17	2/20/2023	JJR	PER FREESTANDING SIGN LOCATION (SHEET C-4 ONLY)
16	11/17/2022	JJR	PER PSE&G SERVICE CONNECTION
15	7/15/2022	JJR	PER PSE&G COMMENTS
14	3/11/2022	JJR	REV. TRANSFORMER LOCATION PER PSE&G COMMENTS
13	3/4/2022	JJR	FOR MUNICIPAL RESUBMISSION
12	1/24/2022	JJR	PER PSE&G COMMENTS
11	9/28/2021	BJD	FOR SCD RESUBMISSION
1	9/24/2019	DBB	FOR CLIENT REVIEW



STONEFIELD
engineering & design

Rutherford, NJ · New York, NY
Princeton, NJ · Tampa, FL · Detroit, MI
www.stonefielddesign.com

Headquarters: 92 Park Avenue, Rutherford, NJ 07070
Phone 201.340.4468 · Fax 201.340.4472

PRELIMINARY AND FINAL MAJOR SITE PLAN

CHELSEA AT FAIR LAWN

**PROPOSED ASSISTED LIVING AND
INDEPENDENT SENIOR LIVING
FACILITIES**

BLOCK 5724, LOTS 1, 02, 4, & 4.01
1600 RIVER ROAD
BOROUGH OF FAIR LAWN
BERGEN COUNTY, NEW JERSEY

cl.d.

CHARLES D. OLIVO, P.E.
NEW JERSEY LICENSE No. 46719
LICENSED PROFESSIONAL ENGINEER



SCALE: 1" = 40' PROJECT ID: T-19233

TITLE: **PROPOSED SIGN
LINE OF SIGHT
EXHIBIT**

DRAWING: **EXHIBIT**