

KEY SHEET

I HEREBY CERTIFY THAT THIS MAP HAS BEEN MADE UNDER MY IMMEDIATE SUPERVISION AND COMPLES WITH THE LAWS OF THE STATE OF NEW JERSEY

WILLIAM SCHINDLER, JR., PLS LIC. NO. GS27188

I HEREBY CERTIFY THAT THIS MAP HAS BEEN REVISED UNDER MY IMMEDIATE SUPERVISION AND COMPLES WITH THE LAWS OF THE STATE OF NEW JERSEY

BRUCE D. RIGG, P.E., P.L.S. LIC. NO. G822720

LEGEND

PERSHING ST.

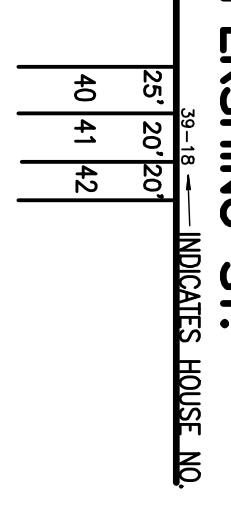

KEY SHEET

48 DENOTES DETAIL SHEET NUMBER

3202 DENOTES BLOCK NUMBER

--- SHEET LIMIT

--- BLOCK LIMIT

DETAIL SHEETS

2814 DENOTES BLOCK NUMBER

5 DENOTES LOT NUMBER

THE FIRST TWO DIGITS OF A FOUR DIGIT BLOCK NUMBER INDICATE THE SHEET NUMBER
EXAMPLE: BLOCK 1802 WILL BE FOUND ON SHEET 18

THIS TAX MAP SUPERCEDES THE TAX MAP APPROVED SEPTEMBER 23, 1932

THE AREAS, BOUNDARIES AND DIMENSIONS ON THIS MAP ARE TO BE USED FOR ASSESSMENT PURPOSES ONLY.
NOTE: THERE ARE NO SHEETS 1 THRU 10, 19 THRU 21, 29 THRU 31, 40 THRU 42, 50 THRU 53, 60 THRU 64 AND 67 ON THIS MAP.

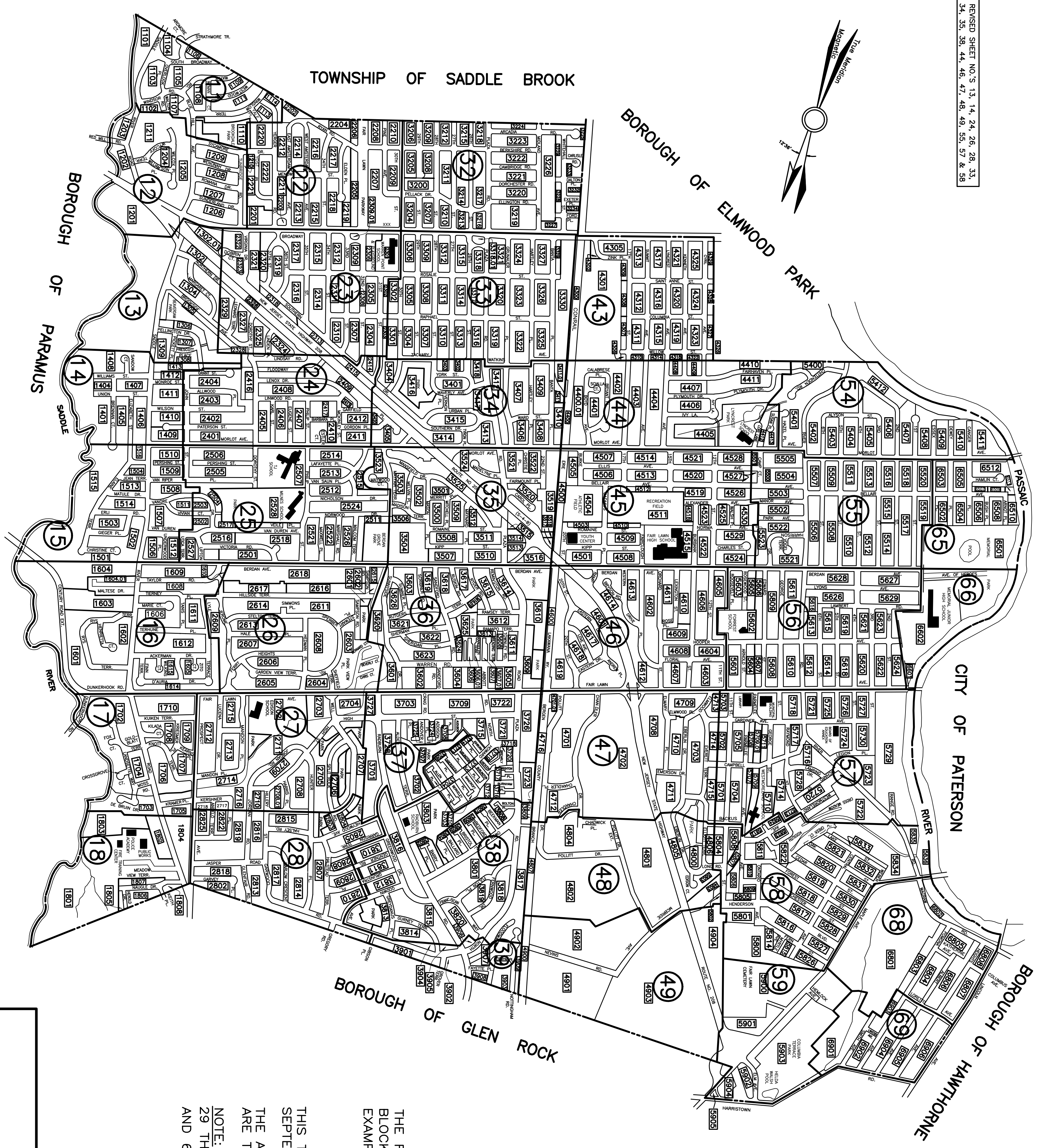

DATE	REVISIONS	NO.
9/20/05	BIRDSALL ENGINEERING, INC. WILLIAM SCHINDLER, JR., PLS	GS27188
1/17/06	BIRDSALL ENGINEERING, INC. WILLIAM SCHINDLER, JR., PLS	GS27188
1/31/08	BRUCE D. RIGG, P.E., P.L.S.	G822720
6/1/10	BRUCE D. RIGG, P.E., P.L.S.	G822720
1/11/11	BRUCE D. RIGG, P.E., P.L.S.	G822720

REVISED SHEET NO.'S 13, 14, 24, 26, 28, 33, 34, 35, 38, 44, 46, 47, 48, 49, 55, 57 & 58

THIS SHEET HAS BEEN REDRAWN USING COMPUTER AIDED DRAFTING/DESIGN BASED ON THE PREVIOUS TAX MAP PREPARED BY KENNETH R. GARRISON, BOROUGH ENGINEER P.E. LIC. NO. 37838 AND LAST REVISED BY BRUCE D. RIGG, P.E., P.L.S. LIC. NO. 22720, DATED MARCH 2002.

TAX MAP
BOROUGH OF FAIR LAWN
NEW JERSEY
DECEMBER 2004

BIRDSALL ENGINEERING, INC.
611 INDUSTRIAL WAY WEST, EATONTOWN, NEW JERSEY 07724
CERTIFICATE OF AUTHORIZATION NO. 246A27989800
WILLIAM SCHINDLER JR., PROFESSIONAL
LAND SURVEYOR, LIC. NO. GS27188
TO SHOW CONDITIONS AS OF JUNE 2010

KEY SHEET