

Fair Lawn Borough

Recycling & Garbage Handbook

2012



Contents

Curbside Recycling Collection Regulations.....	2
Clothing, Textiles, Scrap Metal, Electronics & Appliances	2
Green Comingle Recycling Barrel Information	2
Recycling Office Information and Borough Holidays.....	3
Recycling Drop-Off Center	3
Garbage Collection Regulations.....	4
Construction Material Drop Off / Curbside Regulations	5
Common Items – Where do they go?	6
Section Calendars.....	7-11
Fair Lawn Phone & E-Mail Directory	12
Hazardous Waste & Paint Can Disposal	12

Printed on Recycled Paper

Curbside Collection Regulations

Resident Responsibility: It is the responsibility of the resident to recycle properly according to the listed guidelines. Recyclables are to be placed in the correct container and be at the curb for collection by 6 am the day of collection but not before 6 pm the night before collection. You can help avoid missed pickups by not placing your recyclables next to trees, telephone poles, cars or other obstructions and by having the material at the curb for collection at the proper times and in the proper containers. Recyclables may not be placed in the street.

Containers may not be over 40 lbs in weight or larger than 32 gallons in size! NO ITEMS IN PLASTIC BAGS ARE ACCEPTED!

[P] Paper & Cardboard:

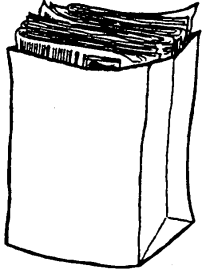

Yes: Newspapers, magazines, junk mail, cereal boxes, cardboard boxes, books (hard covers removed), empty pizza boxes, wrapping paper and SHREDDED PAPER
No: styrofoam, wall paper, wood, paper contaminated with body fluids or wax coated paper (milk or juice containers).

Placement at Curb: String tie in bundles no higher than 12 inches, paper bags or in cardboard boxes. Cardboard boxes must be broken down for easier handling (string tie or place in another box). Paper and cardboard will **not** be collected if it is placed in a sturdy container or garbage can **unless it displays the blue decal issued by the Recycling Office**. Blue decals are available by calling the Recycling Office. The green Borough recycling barrel is prohibited from being used as a container for cardboard or paper.

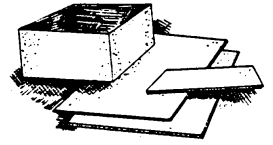

[C] Bottles, Cans & Plastic Containers (Commingle): -



Yes: Glass bottles and jars, aluminum cans, aluminum foil, tin cans, any #1 to #7 plastic containers and wax coated containers (milk, juice, etc.)

No: Mirrors, light bulbs, ceramics, dishes, frosted glass, leaded crystal, safety glass, mugs, microwaveable glass, food contaminated items, scrap metal, paint cans, toys, styrofoam, plastic bags, saran wrap, or any non-acceptable plastic.

Placement at Curb: Bottles & Cans may **only** be placed in the **green Borough recycling barrel**. Non-Borough barrels may be used if it displays the **red decal issued by the Recycling Office**. Replacement covers are **not** supplied by the Borough.



[Y] Yard Waste:



Yes: Grass, leaves, brush, branches (less than 3 inches in diameter) and Christmas trees.

No: Logs, stumps, construction material, branches (over 3 inches in diameter), furniture, doors, windows, or any lumber.

Placement at Curb: Paper bags or a sturdy container not weighing more than **40 lbs**. Branches must be tied in 3 foot lengths. Christmas trees must be cleaned of all ornaments and tinsel. Yard waste will **not** be collected if placed out in cardboard boxes, plastic bags or the green recycling barrel. No barrels with openings smaller in diameter than the base of the barrel or landscaper barrels.

The following recyclables are collected BY APPOINTMENT ONLY on your recycling day. Please call 201-794-5304 to schedule your collection.

Clothing and Textiles

Yes: Clothes (clean and in good condition) such as pants, shirts, blouses, skirts, dresses, jackets, sweatshirts, baby clothes, sweaters, belts, hats, caps, shoes, boots, gloves (pairs only), scarves, pocketbooks, linens, pillow cases, sheets, tablecloths, curtains, blankets comforters, toys that are smaller than a breadbox and have no small, loose pieces, stuffed animals.

No: hangers, board games or toys with small loose pieces, single shoes, gloves or boots.

Scrap Metal, Appliances & Electronics:

Yes: Refrigerators, stoves, washers, dryers, dishwashers, bed frames, water heaters, ACs, boilers, bicycles, BBQs, or any item that is at least 50% metal content. Electronics include TVs, computers, stereos, VCRs, cell phones and camera equipment.

No: Box springs, mattresses, construction material, plastic, porcelain sinks, tubs, toilets, wood furniture or tanks.

Placement at Curb: Must not be placed in street and may only be at the curb after 6 pm the night before collection. Residents are asked to put the item out in the morning before 6:00 AM. Hot water heaters must have green inspection sticker (with purchase of permit) prior to collection. Refrigerators and freezers must have the doors removed per State Law. Appointments are scheduled for your next available recycling day.

SPECIAL NOTE:

Borough Recycling Barrel: The green Borough recycling barrel is the property of the Borough and is only to be used for commingle recycling collection. Damaged barrels must be returned to the Recycling Office so the serial number is removed from your address. The Council has discontinued the barrel program and no replacement barrels are available at this time. Please mark your address on the barrel. Red decals to be placed on your own barrel will be issued in lieu of new barrels.

Recycling Office – 201-794-5304

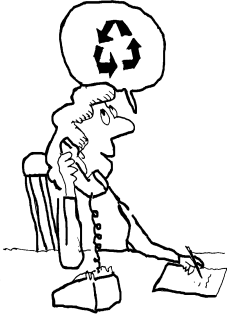

The Recycling Division office is located at the DPW complex at 20-05 Saddle River Road. Due to staffing changes, the office is no longer staffed on a regular basis. All recycling business is conducted in the DPW office in Borough Hall. Construction tickets are now only sold at the DPW office (room 211) and Tax office in Borough Hall Monday to Friday, 7:30 am to 4:00 pm.

Borough Holidays (Dates are as observed by Borough):

New Year's Day (1/2), Martin Luther King Day (1/16), Lincoln's Birthday (2/13), President's Day (2/20), Good Friday (4/6), Easter Sunday (4/8), Memorial Day (5/28), Independence Day (7/4), Labor Day (9/3), Columbus Day (10/8), Veteran's Day (11/12), Thanksgiving (11/22 & 23), Christmas Day (12/25).

Recycling Drop-Off Center

Restrictions:

The drop off center is limited only to Fair Lawn residents and businesses. Proof of residency may be requested at any time. Resident stickers for your vehicle are available at the Recycling Office. Please bring a copy of your driver's license and the registration for each vehicle requiring a sticker or mail copies to the DPW office (PO Box 376, Fair Lawn, NJ 07410).

Location:

The Recycling Center is located at 20-05 Saddle River Road (DPW Complex). From Fair Lawn Avenue turn left onto Saddle River Road and the complex is located about a 1/2 mile on the right hand side.

Hours:

Monday - Friday 7 am to 3:15 pm
Saturday 9 am to 12:45 pm
Sunday Noon to 3:45 pm
(CLOSED all Borough Holidays - including Easter Sunday)

Acceptable Materials:

All materials collected at curbside: Any recyclable that may be placed at the curb for recycling may be brought to the center.



Car Tires: Any car, truck or bicycle tire is accepted as long as it is removed from the rim, though metal rims may be recycled with scrap metal. A small fee of \$1 per car tire and \$3 per truck tire is charged. No commercial establishments may dump tires at the center.

Rechargeable Batteries: Due to recent changes in the making of batteries, making them less hazardous, the Recycling Center will no longer accept regular household batteries. The Center will ONLY accept rechargeable batteries for recycling. Car batteries may be brought to a scrap metal yard or place of purchase for proper disposal.

Used Clothing: Clothing bins are available from several different organizations. Please have your materials contained in a plastic or paper bag and small enough to fit in the container opening. The Recycling office does NOT give receipts for donated items.

Logs / Branches: Any log, stump or branches that are too large for the curbside collection program may be brought to the Center in a private vehicles only. **No** commercial or rented vehicles will be permitted to dump any yard waste at the Center. If you have hired someone to do the work for you they should properly dispose of the yard waste for you, as part of the contracted work.

**NO CONTRACTOR, COMMERCIAL OR RENTED VEHICLES ALLOWED
TO DUMP YARD WASTE OR CONSTRUCTION MATERIALS!
NO EXCEPTIONS!**

NO HOUSEHOLD GARBAGE ACCEPTED!

**PREMISES IS UNDER 24 HOUR VIDEO SURVEILLANCE.
ILLEGAL DUMPING AND TRESPASSING WILL
BE PROSECUTED TO THE FULLEST EXTENT OF
THE LAW!**



Garbage Collection

201-991-5400

Garbage Contractor:

The Borough is contracted with Cali Carting. All garbage complaints, including missed collections, should be directed to Cali Carting directly. Their phone number is 201-991-5400 or e-mail info@calicarting.com (visit their website at www.calicarting.com). Additional assistance may be provided through the Fair Lawn Recycling Division at 201-794-5304.

Garbage Holidays:

The garbage contractor will not collect on the following holidays: New Years Day, Memorial Day, July 4th, Labor Day, Thanksgiving and Christmas. Consult the collection calendar for your section for the next garbage day.

Container Requirements:

Garbage containers not only prevent animals from scavenging for food they also provide a means for the garbage collection personnel to carry and deposit your garbage into the collection truck. The following guidelines will help prevent litter as well as assist the garbage collection personnel in collecting more efficiently.

- ✓ Any metal or plastic barrel with a tight fitting lid that is not over 32 gallons in size. Pickle barrels are not acceptable or those with a lid opening smaller than the base of the can.
- ✓ Garbage containers may not weigh over 50 pounds. **(RGO 204.8(b))**
- ✓ No more than 4 containers or a total weight of 200 pounds may be put out for collection. Apartments buildings, businesses and houses of worship are limited to 500 pounds for any collection.
- ✓ *Cardboard boxes are prohibited from being used as a container and must be recycled as per regulations on page 2.*
- ✓ *The green Borough Recycling Barrel is prohibited from being used to hold garbage and may only be used for placement of bottles and can recycling materials.*
- ✓ **Loose plastic bags are not acceptable. Garbage must be placed in a sturdy container. (RGO 204.3)**



Placement at Curb Regulations:

The following regulations must be adhered to when placing garbage at the curb for collection. Failure to do so may result in non-collection and/or a summons.

- ✓ Garbage or recycling may not be placed in the street. All items must be left between the curb and sidewalk. **(RGO 204-6)**
- ✓ Rugs, carpets and padding must be rolled and tied in 3 foot (or smaller) lengths. Limited to the 200 pound rule.
- ✓ Garbage may not be placed at the curb before **6 pm** the night before collection but **must be** at the curb by 5 am the morning of collection.

Bulky Materials:

Fair Lawn does not require bulky materials to be set out on special days but no more than one bulky item may be placed at the curb on each regular collection day. Bulky items include mattresses, box springs, dressers, furniture, etc. Do NOT break the item up or the contractor may think that it is construction material and refuse to collect it.

Remember that **metal items and electronics** such as appliances, bed frames, TVs, computers, etc. must be recycled. See the requirements for curbside recycling collection on page 2 for further details.

Collection Times:

Collection routes are set by the contractor and may be changed at their discretion. All garbage must be placed at the curb for collection by **5 am** the day of collection. Any material placed at the curb later than this time risks not being collected.

Please refrain from calling if your garbage is not collected by its "normal" time. A number of things, including weather, truck breakdowns, road paving, etc., may occur that could detain the contractor from collecting the route and this could result in a delay in service. The contractor has until 6 PM to finish the route.

Prohibited Materials:

The following items are not collected as part of the garbage collection:

- ✓ Construction material (including concrete) (it is the responsibility of the contractor or homeowner doing the work).
- ✓ Recyclables must be recycled as defined elsewhere in this booklet.
- ✓ Asbestos, paint, chemicals or other hazardous materials.
- ✓ Rocks, sod, dirt or yard waste.

Construction Material

Concrete, asphalt and brick must be recycled. Residents and contractors should turn in their recycling weight receipts to the Recycling Office so the Borough can earn recycling grant money!

Construction material is the responsibility of the generator (homeowner, business, contractor). When doing construction on your home you have several options regarding its disposal. Regardless of the option that you choose for disposal, you are responsible to assure that it is done legally as outlined by all Federal, State and Borough laws.

Option 1: Contractor Disposal:

When you enter into a contract for a contractor to do renovations to your home or business, make provisions for the contractor to dispose of the materials.

Option 2: Hire a Sanitation Contractor:

Many residents are now taking on "do-it-yourself" or DIY projects. Consider renting a dumpster from a sanitation company. Residents are reminded that a permit is required for placement in the street and is issued by the Department of Public Works.

Option 3: Bring the Material to a DEP Approved Transfer Facility:

The facilities listed below are approved by NJ DEP for accepting solid waste and construction materials. Residents are advised to contact the facility to confirm that they will accept the waste, what costs are involved and what rules or regulations need to be followed when dumping at their facility. The residents are responsible for all costs.

Company Name	Phone	Address	City
Miele Sanitation Co., Inc.	(201) 768-5407	60 Railroad Ave.	Closter
I.W.S. Transfer System of NJ, Inc.	(973) 340-0431	19-35 Atlantic St.	Garfield
WMNJI-Hillsdale Transfer Station	(201) 664-6010	77 Brookside Place	Hillsdale
National Transfer, Inc.	(973) 778-4764	445 N Main St.	Lodi
S & L Zepetelli, Inc.	(201) 440-8092	191 Moonachie Rd.	Moonachie
WMNJI -No. Arlington	(201) 997-1800	100 Baler Blvd.	No. Arlington
WMNJI-Park Ridge	(201) 391-4355	94 Perry St.	Park Ridge
Braen Stone (asphalt, stone, concrete)	(973) 595-6250	400 Central Ave.	Haledon
Tilcon (asphalt, stone, concrete)	(973) 389-2343	Planten Ave.	Haledon

Option 4: Bring it to the Fair Lawn Recycling Center for a Fee:

The Fair Lawn Recycling Center will accept construction material from Fair Lawn residents in their private vehicles. Commercial and rented vehicles are prohibited from dumping construction material at the center. Residents are required to purchase vouchers at the DPW Office or Tax Office prior to dumping construction at the center. Vouchers are \$25 each. A passenger car or a trailer requires one (1) voucher per trip. SUVs, vans and pick-up trucks require two (2) vouchers per trip. Vouchers are non-refundable and expire after one year.

Construction tickets are sold at the DPW Office and Tax Office, open from 8:30 AM to 4:00 PM in Borough Hall. The offices are closed on all Borough holidays.

The Recycling Center is open to accept construction material, with proper vouchers, Monday to Friday from 7:00 AM to 3:15 PM, Saturdays from 9:00 AM to 12:45 PM and Sundays from Noon to 3:45 PM (The center is closed on all Borough holidays and Major holidays that fall on a weekend day such as Easter Sunday).

Construction materials include building wood, paneling, sheet rock, tiles, toilets, sinks, wood doors, windows, cabinetry, countertops and garage doors. Construction does NOT include recyclables, hazardous materials, brick, block, stone, concrete, asphalt, stone, rocks, dirt, etc.

Option 5: Free Curbside Collection:

As a courtesy to the residents, the Borough's garbage contractor will accept small amounts (4 barrels worth or 200 pounds) of construction material on garbage day twice per year during the designated weeks. Materials over the 4 barrel limit will not be collected. **The 2012 collections are during the weeks of May 7th and October 22nd.**

Construction materials include building wood, paneling, sheet rock, tiles, toilets, sinks, wood doors, windows, cabinetry, countertops and garage doors. Construction does NOT include recyclables, hazardous materials, brick, block, stone, concrete, asphalt, stone, rocks, dirt, etc.

Where Does It Go?

The following list are the most common items and where they are to be properly discarded. If you have any questions, please call the Recycling office at 201-794-5304 or e-mail: recycling@fairlawn.org.

Item	Where it Goes	Item	Where it Goes
Appliances	Metal Collection (p.2)	Hazardous Materials	BCUA Hazmat Collection
Asphalt	Borough does not collect	Helium Tanks	Remove valve, then Metal
Batteries – rechargeable	Recycling Center Drop-Off	Hot Water Heater	Metal Collection w/green sticker
Batteries – Car / Truck	BCUA Hazmat Collection	Junk Mail	Paper Collection
Block (cinder, etc.)	Borough does not collect	Leaves	Yard Waste Collection
Books – hardcover	Remove covers for paper recycling	Light Bulbs	Garbage
Books – softcover	Paper Collection	Light Bulbs—Fluorescent	BCUA Hazmat Collection
Box Spring	Garbage	Logs / Stumps	Recycling Center Drop-Off
Brick	Borough does not collect	Mattress	Garbage
Brush / Branches	Yard Waste Collection	Mirrors	Garbage
Cardboard	Paper Collection	Paint	BCUA Hazmat Collection
Carpet	Garbage – tied in 3 ft. lengths	Paneling	See construction materials (p.5)
Chemicals	BCUA Hazmat Collection	Picnic Table	Garbage (do not break up)
Clothing	Curbside Clothing Collection (p.2)	Plastic Bags	Garbage
Computers & Accessories	Metal Collection	Salt, bagged	Garbage
Concrete	Borough does not collect	Sheet Rock	See construction materials (p.5)
Concrete mix (in bag)	Garbage	Sink—metal	Metal Collection (p.2)
Construction materials	See construction materials (p.5)	Sink—porcelain	See construction materials (p.5)
Dirt	Borough does not collect	Stereo	Electronics Collection (p.2)
Dishes	Garbage	Styrofoam	Garbage
Doors	See construction materials (p.5)	Televisions	Electronics Collection (p.2)
Electronics	Electronics Collection (p.2)	Textiles	Clothing Collection (p.2)
Fence— metal	Metal Collection (p.2)	Toilets	See construction materials (p.5)
Fence— wood	See construction materials (p.5)	Toys	Garbage
Furnace	Metal Collection (p.2)	Water Softener	Garbage
Furniture – Metal	Metal Collection (p.2)	Wood, processed	See construction materials (p.5)
Furniture – Non-Metal	Garbage – 1 pc. Per collection		
Grass	Yard Waste Collection		

Borough Section Map

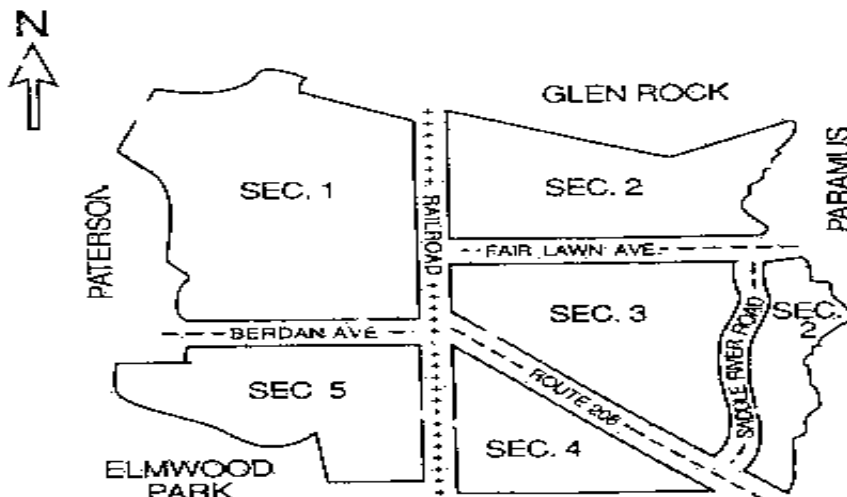

The Borough is divided into five sections.

If you are unsure of your section please call the Recycling Division.

If you are located on one of the streets that splits two sections then you are collected in the section that your side of the road touches.

Please consult the correct section calendar for your collection days.

Recycling
Cancelled on
School Snow Days

SECTION 1

Fair Lawn Recycling / Garbage Schedule

Effective
January 1
2012

January						
S	M	T	W	T	F	S
1	H	P	4	5	6	7
8	9	C/X	11	12	13	14
15	H	P	18	19	20	21
22	23	C	25	26	27	28
29	30	P				

February						
S	M	T	W	T	F	S
			1	2	3	4
5	6	C	8	9	10	11
12	H	P	15	16	17	18
19	H	C	22	23	24	25
26	27	P	29			

March						
S	M	T	W	T	F	S
				1	2	3
4	5	C	7	8	9	10
11	12	P	14	15	16	17
18	19	C	21	22	23	24
25	26	P	28	29	30	31

April						
S	M	T	W	T	F	S
1	2	C/Y	4	5	H	7
H	9	P/Y	11	12	13	14
15	16	C/Y	18	19	20	21
22	23	P/Y	25	26	27	28
29	30					

May						
S	M	T	W	T	F	S
		C/Y	2	3	4	5
6	7	P/Y	D	10	11	12
13	14	C/Y	16	17	18	19
20	21	P/Y	23	24	25	26
27	H	C	30	31		

June						
S	M	T	W	T	F	S
					1	2
3	4	P/Y	6	7	8	9
10	11	C/Y	13	14	15	16
17	18	P/Y	20	21	22	23
24	25	C/Y	27	28	29	30

July						
S	M	T	W	T	F	S
1	2	P/Y	H	5	6	7
8	9	C/Y	11	12	13	14
15	16	P/Y	18	19	20	21
22	23	C/Y	25	26	27	28
29	30	P/Y				

August						
S	M	T	W	T	F	S
			1	2	3	4
5	6	C/Y	8	9	10	11
12	13	P/Y	15	16	17	18
19	20	C/Y	22	23	24	25
26	27	P/Y	29	30	31	

September						
S	M	T	W	T	F	S
						1
2	H	C	5	6	7	8
9	10	P/Y	12	13	14	15
16	17	C/Y	19	20	21	22
23	24	P/Y	26	27	28	29
30						

October						
S	M	T	W	T	F	S
	1	C/Y	3	4	5	6
7	H	P	10	11	12	13
14	15	C/Y	17	18	19	20
21	22	P/Y	D	25	26	27
28	29	C/Y	31			

November						
S	M	T	W	T	F	S
				1	2	3
4	5	P/Y	7	8	9	10
11	H	C	14	15	16	17
18	19	P	21	H	H	24
25	26	C/Y	28	29	30	

December						
S	M	T	W	T	F	S
						1
2	3	P/Y	5	6	7	8
9	10	C/Y	12	13	14	15
16	17	P	19	20	21	22
23	24	H	26	C	28	29
30	31					

Important Phone Numbers

Garbage: 201- 991-5400
 Recycling: 201-794-5304
 Hazardous Waste: 201-807-5825

By Appointment only:
All metal items & appliances
Clothing / Textiles
Electronics

Legend

C = Commingle P = Paper & Cardboard
 Y = Yard Waste H = Borough Holiday
 X = Christmas Trees D = Construction

= Garbage collection

Recycling
Cancelled on
School Snow Days

SECTION 2

Fair Lawn Recycling / Garbage Schedule

Effective
January 1
2012

January						
S	M	T	W	T	F	S
1	H	3	P	5	6	7
8	9	10	C/X	12	13	14
15	H	17	P	19	20	21
22	23	24	C	26	27	28
29	30	31				

February						
S	M	T	W	T	F	S
			P	2	3	4
5	6	7	C	9	10	11
12	H	14	P	16	17	18
19	H	21	C	23	24	25
26	27	28	P			

March						
S	M	T	W	T	F	S
				1	2	3
4	5	6	C	8	9	10
11	12	13	P	15	16	17
18	19	20	C	22	23	24
25	26	27	P	29	30	31

April						
S	M	T	W	T	F	S
1	2	3	C/Y	5	H	7
H	9	10	P/Y	12	13	14
15	16	17	C/Y	19	20	21
22	23	24	P/Y	26	27	28
29	30					

May						
S	M	T	W	T	F	S
		1	C/Y	3	4	5
6	7	8	P/Y	D	11	12
13	14	15	C/Y	17	18	19
20	21	22	P/Y	24	25	26
27	H	29	C/Y	31		

June						
S	M	T	W	T	F	S
					1	2
3	4	5	P/Y	7	8	9
10	11	12	C/Y	14	15	16
17	18	19	P/Y	21	22	23
24	25	26	C/Y	28	29	30

July						
S	M	T	W	T	F	S
1	2	3	H	5	P	7
8	9	10	C/Y	12	13	14
15	16	17	P/Y	19	20	21
22	23	24	C/Y	26	27	28
29	30	31				

August						
S	M	T	W	T	F	S
			P/Y	2	3	4
5	6	7	C/Y	9	10	11
12	13	14	P/Y	16	17	18
19	20	21	C/Y	23	24	25
26	27	28	P/Y	30	31	

September						
S	M	T	W	T	F	S
						1
2	H	4	C/Y	6	7	8
9	10	11	P/Y	13	14	15
16	17	18	C/Y	20	21	22
23	24	25	P/Y	27	28	29
30						

October						
S	M	T	W	T	F	S
	1	2	C/Y	4	5	6
7	H	9	P/Y	11	12	13
14	15	16	C/Y	18	19	20
21	22	23	P/Y	D	26	27
28	29	30	C/Y			

November						
S	M	T	W	T	F	S
				1	2	3
4	5	6	P/Y	8	9	10
11	H	13	C/Y	15	16	17
18	19	20	P	H	23	24
25	26	27	C/Y	29	30	

December						
S	M	T	W	T	F	S
						1
2	3	4	P/Y	6	7	8
9	10	11	C/Y	13	14	15
16	17	18	P	20	21	22
23	24	H	C	27	28	29
30	31					

Important Phone Numbers

Garbage: 201-991-5400
 Recycling: 201-794-5304
 Hazardous Waste: 201-807-5825

By Appointment only:
All metal items & appliances
Clothing / Textiles
Electronics.

Legend

C = Commingle P = Paper & Cardboard
 Y = Yard Waste H = Borough Holiday
 X = Christmas Trees D = Construction

= Garbage collection

Recycling
Cancelled on
School Snow Days

SECTION 3

Fair Lawn Recycling / Garbage Schedule

Effective
January 1
2012

January						
S	M	T	W	T	F	S
1	2	3	4	5	P	7
8	9	10	11	12	C/X	14
15	16	17	18	19	P	21
22	23	24	25	26	C	28
29	30	31				

February						
S	M	T	W	T	F	S
			1	2	P	4
5	6	7	8	9	C	11
12	13	14	15	16	P	18
19	20	21	22	23	C	25
26	27	28	29			

March						
S	M	T	W	T	F	S
				1	P	3
4	5	6	7	8	C	10
11	12	13	14	15	P	17
18	19	20	21	22	C	24
25	26	27	28	29	P	31

April						
S	M	T	W	T	F	S
1	2	3	4	C	H	7
H	9	10	11	12	P/Y	14
15	16	17	18	19	C/Y	21
22	23	24	25	26	P/Y	28
29	30					

May						
S	M	T	W	T	F	S
		1	2	3	C/Y	5
6	D	8	9	10	P/Y	12
13	14	15	16	17	C/Y	19
20	21	22	23	24	P/Y	26
27	H	29	30	31		

June						
S	M	T	W	T	F	S
					C/Y	2
3	4	5	6	7	P/Y	9
10	11	12	13	14	C/Y	16
17	18	19	20	21	P/Y	23
24	25	26	27	28	C/Y	30

July						
S	M	T	W	T	F	S
1	2	3	H	5	P	7
8	9	10	11	12	C/Y	14
15	16	17	18	19	P/Y	21
22	23	24	25	26	C/Y	28
29	30	31				

August						
S	M	T	W	T	F	S
			1	2	P/Y	4
5	6	7	8	9	C/Y	11
12	13	14	15	16	P/Y	18
19	20	21	22	23	C/Y	25
26	27	28	29	30	P/Y	

September						
S	M	T	W	T	F	S
						1
2	H	4	5	6	C/Y	8
9	10	11	12	13	P/Y	15
16	17	18	19	20	C/Y	22
23	24	25	26	27	P/Y	29
30						

October						
S	M	T	W	T	F	S
	1	2	3	4	C/Y	6
7	8	9	10	11	P/Y	13
14	15	16	17	18	C/Y	20
21	D	23	24	25	P/Y	27
28	29	30	31			

November						
S	M	T	W	T	F	S
				1	C/Y	3
4	5	6	7	8	P/Y	10
11	12	13	14	15	C/Y	17
18	19	P	21	H	H	24
25	26	27	28	29	C/Y	

December						
S	M	T	W	T	F	S
						1
2	3	4	5	6	P/Y	8
9	10	11	12	13	C/Y	15
16	17	18	19	20	P	22
23	24	H	26	27	C	29
30	31					

Important Phone Numbers

Garbage: 201-991-5400
 Recycling: 201-794-5304
 Hazardous Waste: 201-807-5825

By Appointment only:
All metal items & appliances
Clothing / Textiles
Electronics

Legend

C = Commingle P = Paper & Cardboard
 Y = Yard Waste H = Borough Holiday
 X = Christmas Trees D = Construction

= Garbage collection

Recycling
Cancelled on
School Snow Days

SECTION 4

Fair Lawn Recycling / Garbage Schedule

Effective
January 1
2012

January						
S	M	T	W	T	F	S
1	H	3	4	P	6	7
8	9	10	11	C/X	13	14
15	H	17	18	P	20	21
22	23	24	25	C	27	28
29	30	31				

February						
S	M	T	W	T	F	S
			1	P	3	4
5	6	7	8	C	10	11
12	H	14	15	P	17	18
19	H	21	22	C	24	25
26	27	28	29			

March						
S	M	T	W	T	F	S
				P	2	3
4	5	6	7	C	9	10
11	12	13	14	P	16	17
18	19	20	21	C	23	24
25	26	27	28	P	30	31

April						
S	M	T	W	T	F	S
1	2	3	4	C	H	7
H	9	10	11	P/Y	13	14
15	16	17	18	C/Y	20	21
22	23	24	25	P/Y	27	28
29	30					

May						
S	M	T	W	T	F	S
		1	2	C/Y	4	5
6	7	D	9	P/Y	11	12
13	14	15	16	C/Y	18	19
20	21	22	23	P/Y	25	26
27	H	29	30	C/Y		

June						
S	M	T	W	T	F	S
					1	2
3	4	5	6	P/Y	8	9
10	11	12	13	C/Y	15	16
17	18	19	20	P/Y	22	23
24	25	26	27	C/Y	29	30

July						
S	M	T	W	T	F	S
1	2	3	H	P/Y	6	7
8	9	10	11	C/Y	13	14
15	16	17	18	P/Y	20	21
22	23	24	25	C/Y	27	28
29	30	31				

August						
S	M	T	W	T	F	S
			1	P/Y	3	4
5	6	7	8	C/Y	10	11
12	13	14	15	P/Y	17	18
19	20	21	22	C/Y	24	25
26	27	28	29	P/Y	31	

September						
S	M	T	W	T	F	S
						1
2	H	4	5	C/Y	7	8
9	10	11	12	P/Y	14	15
16	17	18	19	C/Y	21	22
23	24	25	26	P/Y	28	29
30						

October						
S	M	T	W	T	F	S
	1	2	3	C/Y	5	6
7	H	9	10	P/Y	12	13
14	15	16	17	C/Y	19	20
21	22	D	24	P/Y	26	27
28	29	30	31			

November						
S	M	T	W	T	F	S
				C/Y	2	3
4	5	6	7	P/Y	9	10
11	H	13	14	C/Y	16	17
18	19	20	P	H	H	24
25	26	27	28	C/Y	30	

December						
S	M	T	W	T	F	S
						1
2	3	4	5	P/Y	7	8
9	10	11	12	C/Y	14	15
16	17	18	19	P	21	22
23	24	H	26	C	28	29
30	31					

Important Phone Numbers

Garbage: 201-991-5400
 Recycling: 201-794-5304
 Hazardous Waste: 201-807-5825

By Appointment only:
All metal items & appliances
Clothing / Textiles
Electronics

Legend

C = Commingle P = Paper & Cardboard
 Y = Yard Waste H = Borough Holiday
 X = Christmas Trees D = Construction

= Garbage collection

Recycling
Cancelled on
School Snow Days

SECTION 5

Fair Lawn Recycling / Garbage Schedule

Effective
January 1
2012

January						
S	M	T	W	T	F	S
1	H	P	4	5	6	7
8	C/X	10	11	12	13	14
15	H	P	18	19	20	21
22	C	24	25	26	27	28
29	P	31				

February						
S	M	T	W	T	F	S
			1	2	3	4
5	C	7	8	9	10	11
12	H	P	15	16	17	18
19	H	C	22	23	24	25
26	P	28	29			

March						
S	M	T	W	T	F	S
				1	2	3
4	C	6	7	8	9	10
11	P	13	14	15	16	17
18	C	20	21	22	23	24
25	P	27	28	29	30	31

April						
S	M	T	W	T	F	S
1	C/Y	3	4	5	6	7
H	P/Y	10	11	12	13	14
15	C/Y	17	18	19	20	21
22	P/Y	24	25	26	27	28
29	C/Y					

May						
S	M	T	W	T	F	S
		1	2	3	4	5
6	P/Y	8	9	10	D	12
13	C/Y	15	16	17	18	19
20	P/Y	22	23	24	25	26
27	H	C	30	31		

June						
S	M	T	W	T	F	S
					1	2
3	P/Y	5	6	7	8	9
10	C/Y	12	13	14	15	16
17	P/Y	19	20	21	22	23
24	C/Y	26	27	28	29	30

July						
S	M	T	W	T	F	S
1	P/Y	3	H	5	6	7
8	C/Y	10	11	12	13	14
15	P/Y	17	18	19	20	21
22	C/Y	24	25	26	27	28
29	P/Y	31				

August						
S	M	T	W	T	F	S
			1	2	3	4
5	C/Y	7	8	9	10	11
12	P/Y	14	15	16	17	18
19	C/Y	21	22	23	24	25
26	P/Y	28	29	30	31	

September						
S	M	T	W	T	F	S
						1
2	H	C	5	6	7	8
9	P/Y	11	12	13	14	15
16	C/Y	18	19	20	21	22
23	P/Y	25	26	27	28	29
30						

October						
S	M	T	W	T	F	S
	C/Y	2	3	4	5	6
7	H	P	10	11	12	13
14	C/Y	16	17	18	19	20
21	P/Y	23	24	25	D	27
28	C/Y	30	31			

November						
S	M	T	W	T	F	S
				1	2	3
4	P/Y	6	7	8	9	10
11	H	C	14	15	16	17
18	P/Y	20	21	H	23	24
25	C/Y	27	28	29	30	

December						
S	M	T	W	T	F	S
						1
2	P/Y	4	5	6	7	8
9	C/Y	11	12	13	14	15
16	P	18	19	20	21	22
23	C	H	26	27	28	29
30	P					

Important Phone Numbers

Garbage: 201-991-5400
 Recycling: 201-794-5304
 Hazardous Waste: 201-807-5825

By Appointment only:
All metal items & appliances
Clothing / Textiles
Electronics

Legend

C = Commingle P = Paper & Cardboard
 Y = Yard Waste H = Borough Holiday
 X = Christmas Trees D = Construction

= Garbage collection

Fair Lawn Borough Contact List – All Numbers in 201 Area Code

Borough Department Phone and E-Mail Directory: All Emergencies dial 9-1-1

Department	Phone Number	E-Mail Address
Ambulance Corps	797-5321 non-emergency	ambulance@fairlawn.org
Building Dept.	794-5307	buildingdept@fairlawn.org
Community Center	794-5372	recreation@fairlawn.org
Court Administrator	794-5350	court@fairlawn.org
Engineering Dept. / Planning Board	794-5300	engineer@fairlawn.org
Fair Lawn TV (Cablevision Channel 77)	794-5394	fairlawntv@fairlawn.org
Finance	794-5351	finance@fairlawn.org
Fire Department	794-5389 non-emergency	fire@fairlawn.org
Fire Prevention Bureau	794-5408	fireprevention@fairlawn.org
Garbage—Cali Carting	991-5400	info@calicarting.com
Health & Human Services	794-5327	health@fairlawn.org
Manager, Borough	794-5310	manager@fairlawn.org
Mayor's Office	794-5344	mayor@fairlawn.org
Municipal Clerk	794-5340	munclerk@fairlawn.org
Office of Emergency Management	794-5390	oem@fairlawn.org
Police (www.fairlawnpd.com)	796-1400 non-emergency	police@fairlawn.org
Property Maintenance	794-5325	—
Public Works (DPW)	794-5304 or 794-5326	dpw@fairlawn.org
Recreation	796-6746	recreation@fairlawn.org
Recycling	794-5304	recycling@fairlawn.org
Road Division	794-5379	roads@fairlawn.org
Senior Center	796-1191	srcenter@fairlawn.org
Sewer Division	794-5382	sewer@fairlawn.org
Tax Collector	794-5339	taxcollector@fairlawn.org
Water Division – Accounting	794-5334	taxcollector@fairlawn.org
Water Division – Operations	794-5374	waterdept@fairlawn.org
Zoning Department	794-5308	zoningdept@fairlawn.org

Household Hazardous Waste Disposal – 201-807-5825 - www.bcua.org

Hazardous waste is not only dangerous to the environment but has also been linked to cancer and other diseases in humans. Proper disposal is imperative. The Bergen County Utilities Authority (BCUA) hosts a Household Hazardous Waste Clean Up Day several times per year. All Bergen County Residents are able to bring their materials to this event for proper disposal.

(Hours 9 AM to 3 PM—rain or shine):
Bergen Community College, Paramus Rd., Paramus
BC Campgaw Reservation, 200 Campgaw Rd., Mahwah
BCUA, Foot of Empire Blvd., Moonachie

This program is available free of charge to Bergen County Residents only! Proof of residence is required.

The Fair Lawn Recycling Center does NOT accept hazardous waste!



Litter Marshal Program

Nearly everyone has seen someone throw litter from a car window including cigarette butts, empty their ashtray, fast food bags, cups, bottles or some other type of garbage. In 2004, the Fair Lawn Clean Communities program started the Litter Marshal program as a way to report these litter bugs! If you see someone littering, write down their license plate number (including state), date, time, location and what was littered. Then call or write to the number below. This is an anonymous program and you will not need to testify or go to court. Please help us keep Fair Lawn clean!

Report litter bugs:
201-794-5341 or litter@fairlawn.org